

How to Unpack and Attach a Tower for a Flex (Turntable Model) Wrapper

1. Attach the eye bolt to the tower and attach to a lifting apparatus. Use a portable crane or forklift with appropriate lifting device attached.



2. Align the tower with the base. Be careful not to pinch electrical cords. Do not lower all the way onto the base. Lower the tower far enough to thread the cords into the tower.



3. With the tower still suspended from the crane, thread the connection cables through the hole in the bottom of the tower.



5. Lower the base the rest of the way. Align the tower mounting bolts to the base.

6. Bolt tower to base with 4 included bolts. Tighten the bolts, using a 3/4" socket.

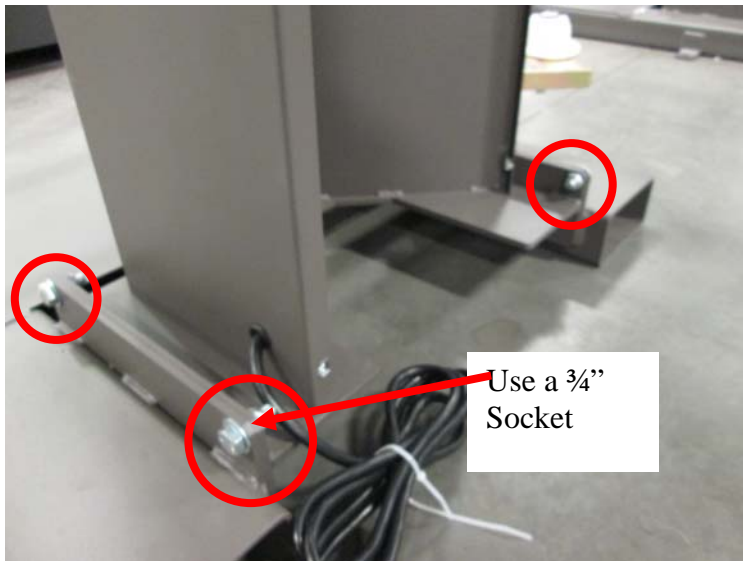

7. Attach the two sensor wires and the motor connector. Make sure the sensor numbers match the wire numbers on the tower and base. Loop cords with wire ties once the tower is in place.



Loop Cords
with Wire
Ties Once
Tower is in
Place



8. Once the tower is secured to the base with all four bolts, remove the eye bolt.

